

POLE PRODUCTION



Polygonal Poles, Highway Poles, Road and Street Lighting Poles.

All kind of pole production capability from 3 m up to 120 m with special design, wind, engineering and static calculations. Environmental friendly and CE Approved pole manufacturing.

Slipjoint and inner-flanged connection systems.

Specially designed lighting pole production with one, two or three body options. Polygon poles can be produced as your wish up to your projects.

Our team is ready for pole production.

Rotational or fixed pulley systems.

POLE PRODUCTION

OCTAGON STREET LIGHTING POLES WITH LONG BRACKET

Illustration of some standard octagonal poles with long arm bracket for Street Lighting applications, complying with specifications. However, specifications can be catered as per the requirements of clients

I. Pole Size (mm)				
"H"	"h"	"d1"	"d2"	"Thk"
6,000	5,000	75	130	4
8,000	7,000	75	156	4
9,000	8,000	75	156	4
10,000	8,000	75	180	4
12,000	10,000	90	250	4
14,000	12,000	90	285	4

II. Arm Size (mm)			
"h1"	"L"	"R"	"ØD x t"
1,000	1,000	700	60.3 x 2.90
1,000	1,500	700	60.3 x 2.90
1,000	1,500	700	60.3 x 2.90
2,000	2,000	1,000	60.3 x 3.65
2,000	2,500	1,500	60.3 x 3.65
2,000	2,500	1,500	60.3 x 3.65

III. Dor Opening (mm)		
"A"	"B"	"C"
600	400	100
600	400	100
600	400	100
600	400	100
600	500	120
600	500	120

Pole + Bracket Details

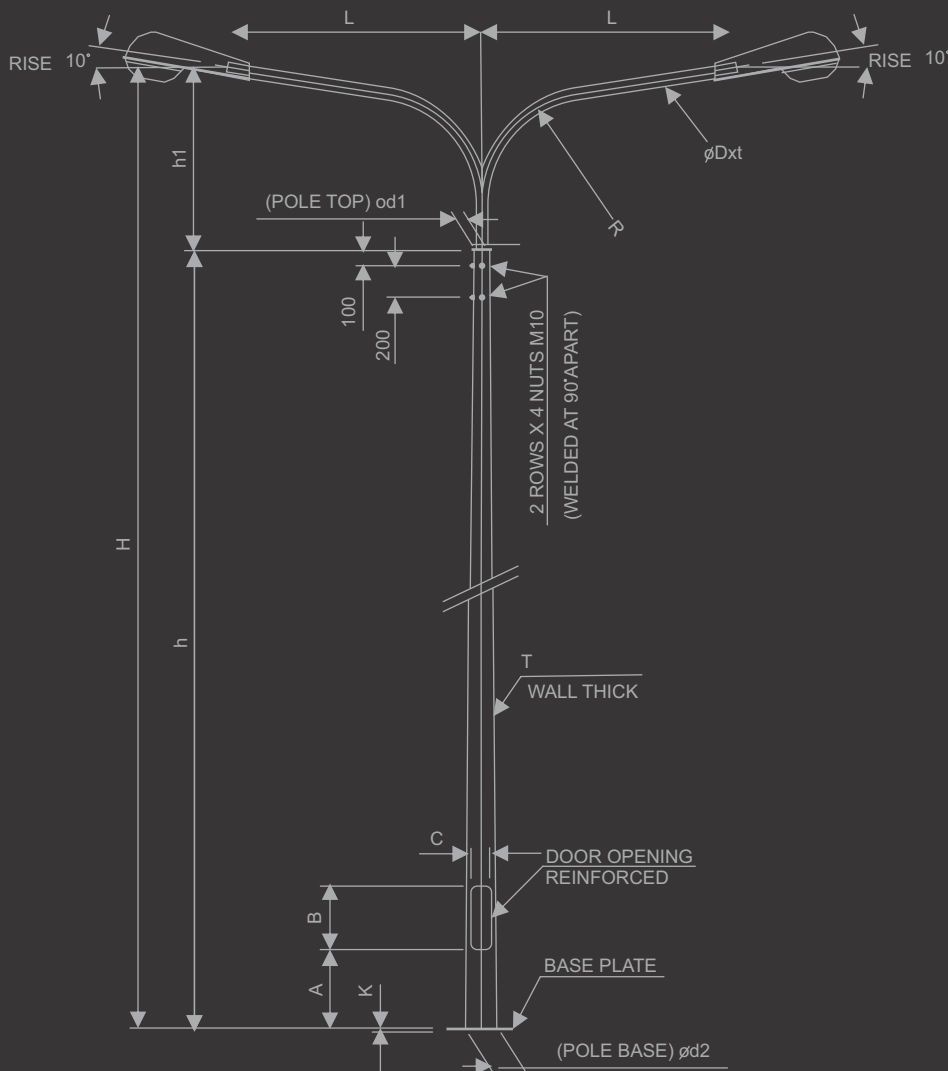

Door Opening Details

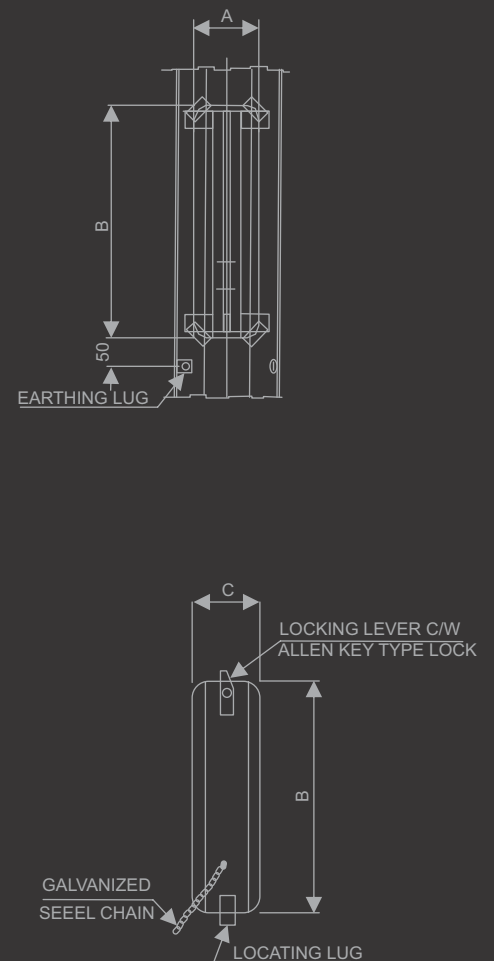

OCTAGON STREET LIGHTING POLES WITH LONG BRACKET

Illustration of some standard octagonal poles with long arm bracket for Street Lighting applications, complying with specifications. However, specifications can be catered as per the requirements of clients

IV. Flange/Base Plate Size (mm)				
"D"	"E"	"F"	"G"	"K"
400	300	22	35	10
400	300	28	45	15
400	300	28	45	15
400	300	28	45	15
400	300	32	50	20
400	350	32	50	20

V. Anchor Bolts Size (mm)			
"ØPxQ"	"R"	"M"	"Qty"
18x400	50	100	4 Nos
24x500	50	100	4 Nos
24x500	50	100	4 Nos
24x500	50	100	4 Nos
27x700	50	100	4 Nos
27x700	75	100	4 Nos

Abbreviations/Notes

Abbreviations :

- I) Pole Size :
H = Overall height
h = Shaft height
d1 = Top dia.
d2 = Bottom dia.
Thk = ShaftWallThickness
- (II) Arm Size:
h 1 = Bracket height,
L = Outreach
R = Radius
Dxt = Diameter x thickness.
- (III) Door Opening:
A= Door opening ht above ground
B = Door size
C = Door width.
- (IV) Flange/Base Plate :
D = Dimension
E = Dist. between holes
F = Hole width
G = Hole length
K = Plate Thickness.
- (V) Anchor Bolts :
P = Bolt dia
Q = Bolt height
R = Radius
N = Bending height
Q = No. of bolts required/Pole.

Flange Plate Details

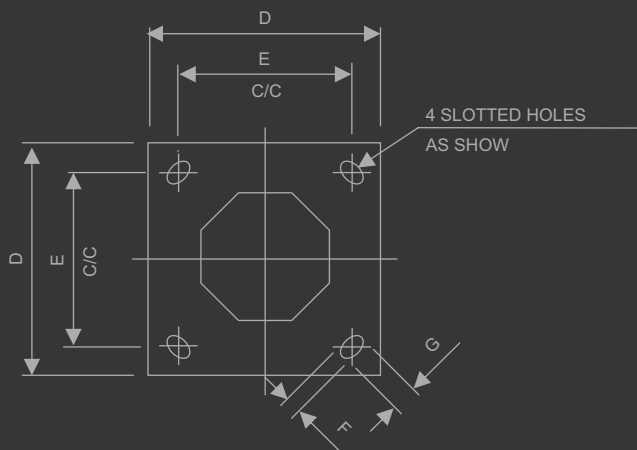

Anchor Bolt Details

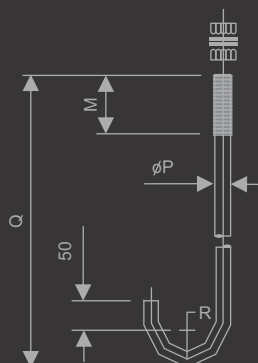

Notes:

1. All dimensions are in mm
2. Design compliance with EN 40:2000 Loads BS CP3, Chapter 5, Part-2
3. Maximum wind speed 160 Km/Hr.
4. Finish: Hot dip galvanized to BS ISO1461 (or as specified).
5. Accessories are made of Mild Steel Grade
6. Shaft made of Steel Grade FE 510C (According to EN 10025).

POLE PRODUCTION

OCTAGON STREET LIGHTING POLES WITH LONG BRACKET

Illustration of some standard octagonal poles with long arm bracket for Street Lighting applications, complying with specifications. However, specifications can be catered as per the requirements of clients

I. Pole Size (mm)			
"H"	"d1"	"d2"	"Thk"
6,000	60	130	4
8,000	60	150	4
9,000	75	165	4
10,000	75	180	4

II. Arm Size (mm)		
"h1"	"L"	"ØD x t"
190	500	60.3 x 2.90
225	700	60.3 x 2.90
275	1,000	60.3 x 2.90
375	1,500	60.3 x 3.65

III. Door Opening (mm)		
"A"	"B"	"C"
600	400	100
600	400	100
600	400	100
600	400	110

Pole + Bracket Details

Door Opening Details

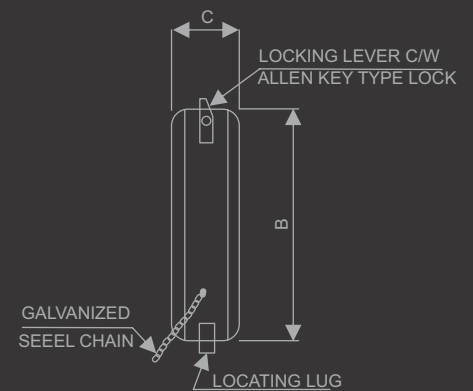
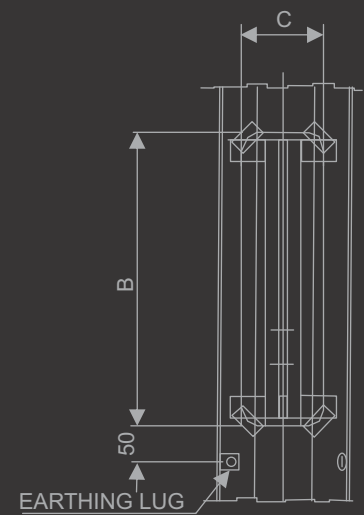
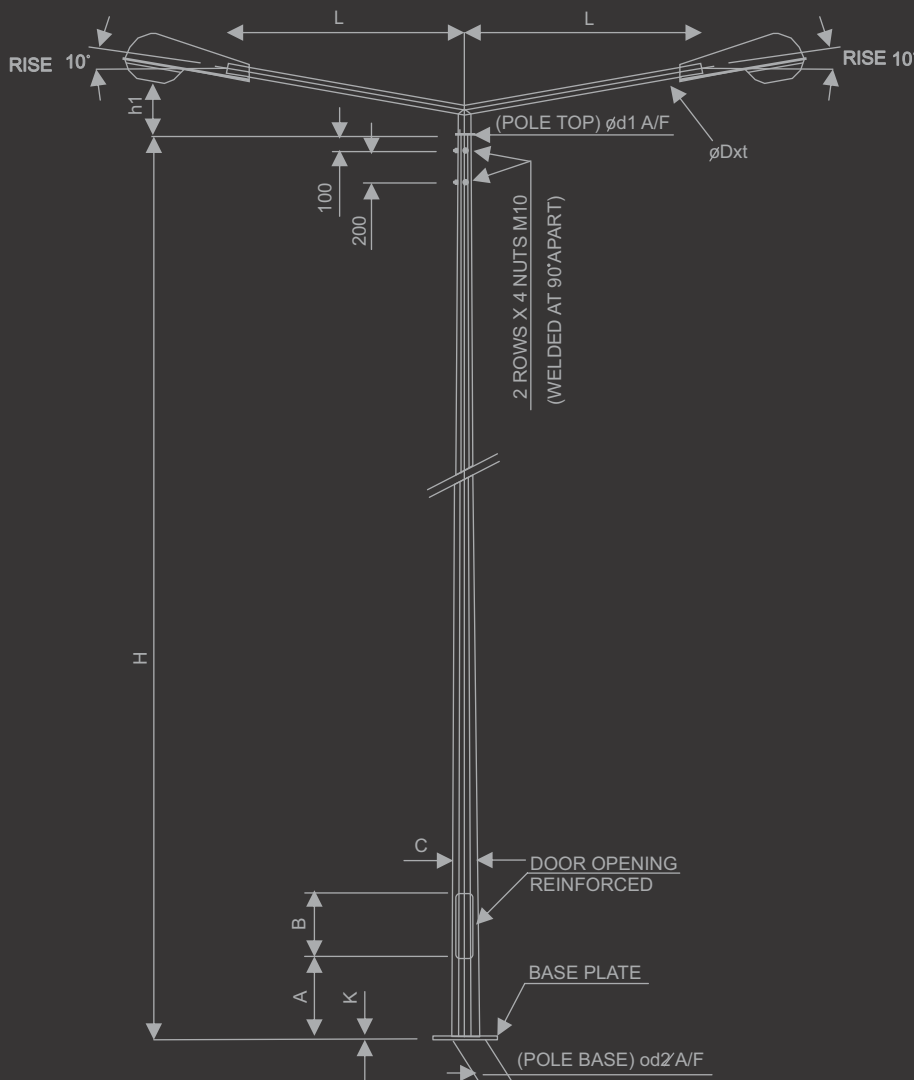

OCTAGON STREET LIGHTING POLES WITH LONG BRACKET

Illustration of some standard octagonal poles with long arm bracket for Street Lighting applications, complying with specifications. However, specifications can be catered as per the requirements of clients

IV. Flange/Base Plate Size (mm)

"D"	"E"	"F"	"G"	"K"
400	300	22	35	10
400	300	28	45	15
400	300	28	45	15
400	300	28	45	15

V. Anchor Bolts Size (mm)

"ØPxQ"	"R"	"M"	"Qty"
18x400	50	100	4 Nos
24x500	50	100	4 Nos
24x500	50	100	4 Nos
24x500	50	100	4 Nos

Abbreviations/Notes

Abbreviations :

- I) Pole Size :
H = Shaft height
d1 = Top dia.
d2 = Bottom dia.
Thk = ShaftWallThickness
- (II) Arm Size:
h 1 = Bracket height,
L = Outreach
Dxt = Diameter x thickness.
- (III) Door Opening:
A= Door opening ht above ground
B = Door size
C = Door width.
- (IV) Flange/Base Plate :
D = Dimension
E = Dist. between holes
F = Hole width
G = Hole length
K = Plate Thickness.
- (V) Anchor Bolts :
P = Bolt dia
Q = Bolt height
R = Radius
N = Bending height
Q = No. of bolts required/Pole.

Flange Plate Details

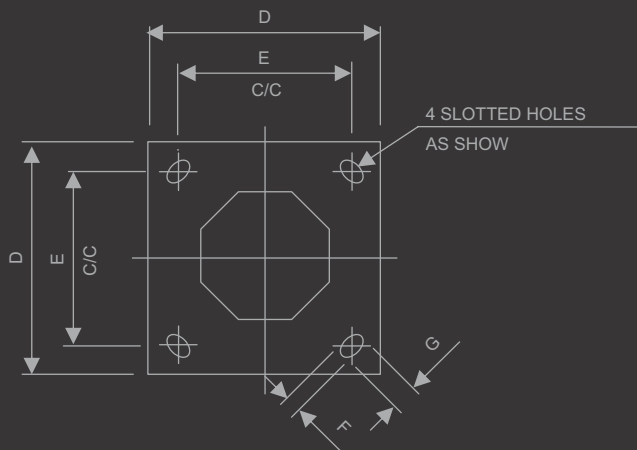

Anchor Bolt Details

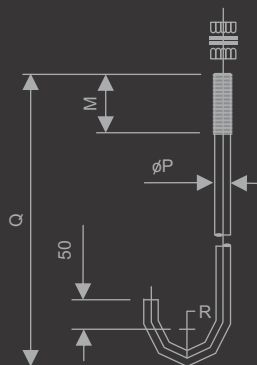

Notes:

1. All dimensions are in mm
2. Design compliance with EN 40:2000 Loads BS CP3, Chapter 5, Part-2
3. Maximum wind speed 160 Km/Hr.
4. Finish: Hot dip galvanized to BS ISO1461 (or as specified).
5. Accessories are made of Mild Steel Grade
6. Shaft made of Steel Grade FE 510C (According to EN 10025).

POLE PRODUCTION

OCTAGON STREET LIGHTING POLES WITH LONG BRACKET

Illustration of some standard octagonal poles with long arm bracket for Street Lighting applications, complying with specifications. However, specifications can be catered as per the requirements of clients

I. Pole Size (mm)

"H"	"d1"	"d2"	"T"	
12.000	90	250	4	—
14.000	90	285	4	—
15.000	105	300	5	4
16.000	105	320	5	4
18.000	105	375	5	4

II. Arm Size (mm)

"h1"	"L"	"OD xt"
200	500	60.3 x 3.00
200	500	60.3 x 3.00
200	500	60.3 x 3.00
200	500	60.3 x 3.00
200	500	60.3 x 3.00

III. Door Opening (mm)

"A"	"B"	"C"
600	500	120
600	500	120
600	500	140
600	500	140
600	500	140

Pole + Bracket Details

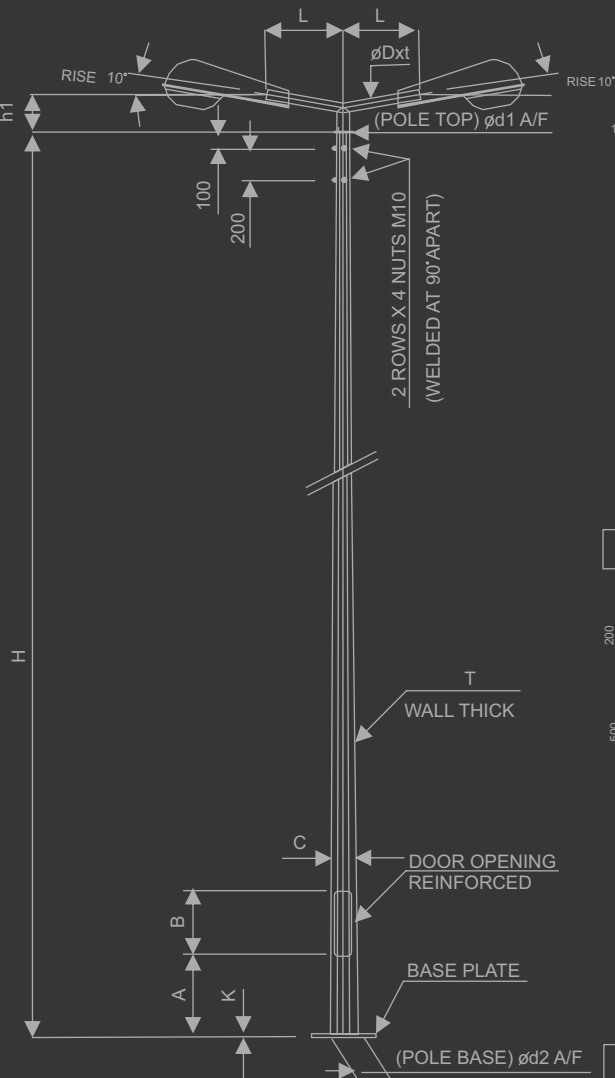

Door Opening Details

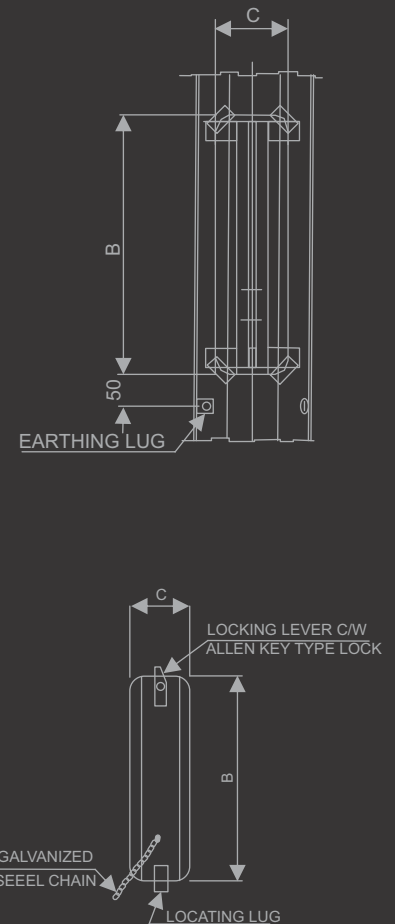

4-Way Bracket Details

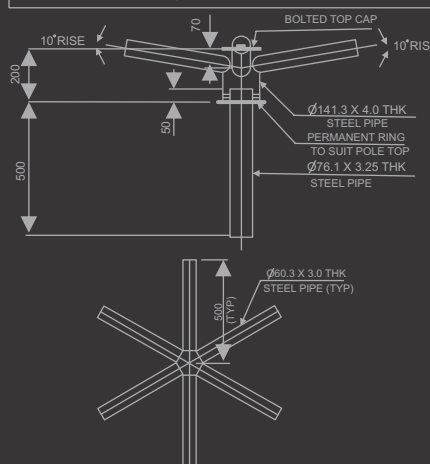

6-Way Bracket Details

OCTAGON STREET LIGHTING POLES WITH LONG BRACKET

Illustration of some standard octagonal poles with long arm bracket for Street Lighting applications, complying with specifications. However, specifications can be catered as per the requirements of clients

IV. Flange/Base Plate Size (mm)				
"D"	"E"	"F"	"G"	"K"
400	300	32	45	20
400	300	32	50	25
450	350	35	50	25
450	350	35	50	30
500	400	38	50	35

V. Anchor Bolts Size (mm)			
"OPxQ"	"R"	"R"	"Qty"
27x700	75	120	4 Nos
27x900	75	150	4 Nos
30x1000	75	150	4 Nos
30x1000	75	150	4 Nos
32x1000	75	150	4 Nos

Abbreviations/Notes

Abbreviations :

- I) Pole Size :
H = Shaft height
d1 = Top dia.
d2 = Bottom dia.
Thk = ShaftWallThickness
- (II) Arm Size:
h 1 = Bracket height,
L = Outreach
Dxt = Diameter x thickness.
- (III) Door Opening:
A= Door opening ht above ground
B = Door size
C = Door width.
- (IV) Flange/Base Plate :
D = Dimension
E = Dist. between holes
F = Hole width
G = Hole length
K = Plate Thickness.
- (V) Anchor Bolts :
P = Bolt dia
Q = Bolt height
R = Radius
N = Bending height
Q = No. of bolts required/Pole.

Flange Plate Details

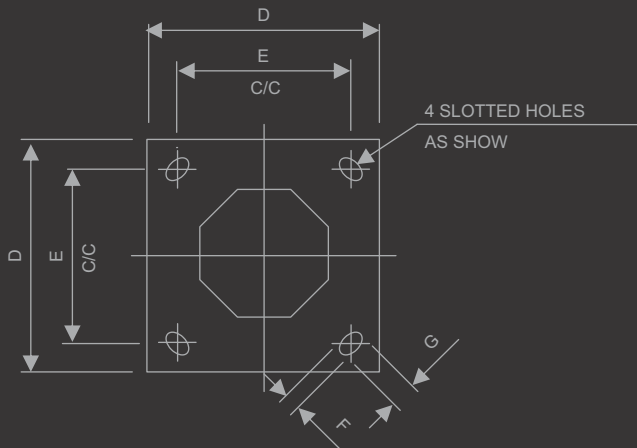

Anchor Bolt Details

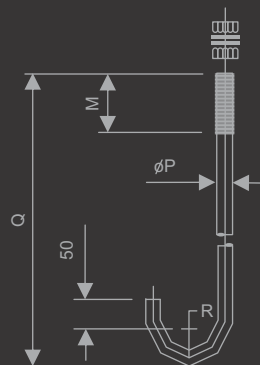

Notes:

1. All dimensions are in mm
2. Design compliance with EN 40:2000 Loads BS CP3, Chapter 5, Part-2
3. Maximum wind speed 160 Km/Hr.
4. Finish: Hot dip galvanized to BS ISO1461 (or as specified).
5. Accessories are made of Mild Steel Grade
6. Shaft made of Steel Grade FE 510C (According to EN 10025).